

# Mayplas

*The Insulation Converter*

## SD 10 Sound Deadening Foam

### Product Guide

Mayplas SD 10 Foam is designed for use as a resilient layer under cement sand screeds in Floor Type 2 constructions (concrete base with floating layer)

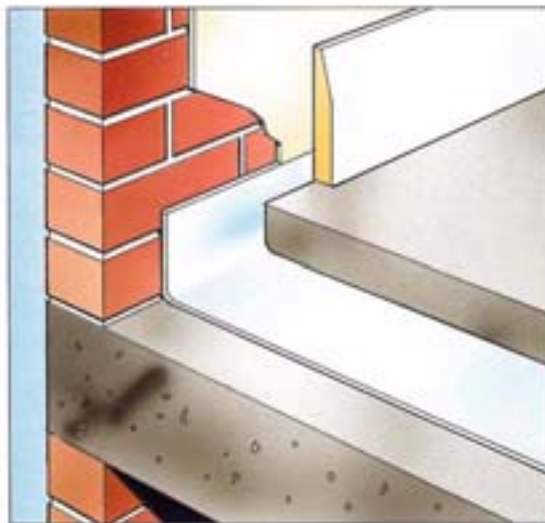

- \* **Easy to fit, cut & join**
- \* **Economical 50m roll length**
- \* **Helps reduce impact sound**
- \* **Wide 1200mm roll for less jointing**



FM 11012

**Peel Industrial Estate - Chamberhall St - Bury - Lancashire BL9 0LU**

**Tel: 0161-447-8320 Fax: 0161-447-8333 E-mail: [sales@mayplas.co.uk](mailto:sales@mayplas.co.uk)**

# Mayplas

## Product Specification SD I O Sound Deadening Foam

<b><u>Thickness:</u></b>	10mm - 11mm
<b><u>Roll Width:</u></b>	1200mm
<b><u>Roll Length:</u></b>	50m
<b><u>Roll Area:</u></b>	60 m <sup>2</sup>
<b><u>Nominal Density:</u></b>	30 kgs/m <sup>3</sup> (minimum)
<b><u>Water Absorption:</u></b>	0.5%
<b><u>Thermal Conductivity:</u></b>	0.033 W/m deg C
<b><u>Working Temperature Range:</u></b>	-80 to +80 deg C
<b><u>Chemical Additive:</u></b>	anti alkaline for direct contact with concrete

### Fitting

If there is any doubt concerning the roughness or cleanliness of the structural concrete base the SD Foam should be laid over a levelling screed to protect it from puncture damage

SD Foam should be carefully butt jointed or overlapped by at least 100mm along its edges and taped at all joints.

It should be turned up at all perimeter walls and detailed at skirting boards and floor frames



FM 11012

**Peel Industrial Estate - Chamberhall St - Bury - Lancashire BL9 OLU**

**09/05**

**Tel: 0161-447-8320 Fax: 0161-447-8333 E-mail: sales@mayplas.co.uk**