

Mayplas

The Insulation Converter

558 Firestop Block

Product Guide

550 Series Firestop Systems have been developed to provide up to 4 hours firestopping at the junctions of compartment walls and floors

The systems have been tested in accordance with BS 476: Part 20:1987

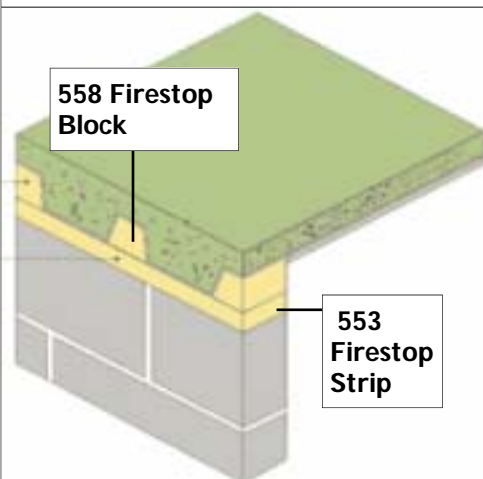

Ordering Information Required

- 1) name of profiled deck
- 2) for upper or lower profile
- 3) dimensions if available
- 4) individual length size if known
- 5) total length for job

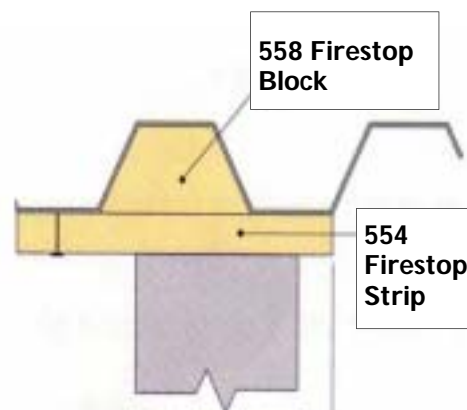

558 Firestop Block is a trapezoidal block for infilling nominated profiled steel deck constructions such as Ribdeck 60, Alphaslok etc

558 Firestop Block is cut to the exact profile of the steel deck to allow for a tight, no compression, fit

Where there is a void between the top of the wall and the soffit of the steel deck Firestop Block can be supported by:-

553 Firestop Strip where the roof profile crosses the wall

or:-554 Firestop Strip where the roof profile runs parallel to the wall

558 Firestop Block is supplied as standard in 1200mm lengths

However in cases where the roof profile crosses the wall it may be easier on site for the contractor to use 558 Firestop Blocks cut to length to match the width of the wall

Mayplas can supply 558 Firestop Block cut to length as required

Installation must provide for a tight and accurate fit, without compression

Lengths of 558 Firestop Block may be joined along the profile by careful and tight butt jointing

Equivalent to Rockwool Conlit Firestop 3B



FM 11012

Peel Industrial Estate - Chamberhall St - Bury - Lancashire BL9 0LU

Tel: 0161-447-8320 Fax: 0161-447-8333 E-mail: sales@mayplas.co.uk