

Mayplas

The Insulation Converter

555 Thermal Cavity Closer

Product Guide

Mayplas Thermal Cavity Closer is designed for use as an insulated dpc between the outer brickwork and inner closer blockwork around door and window frames in masonry cavity type walls

Installation minimises cold bridges and meets the requirements of Part 'L' of The Building Regulations (England & Wales) and Part 'J' of The Building Regulations (Scotland) and NHBC standards

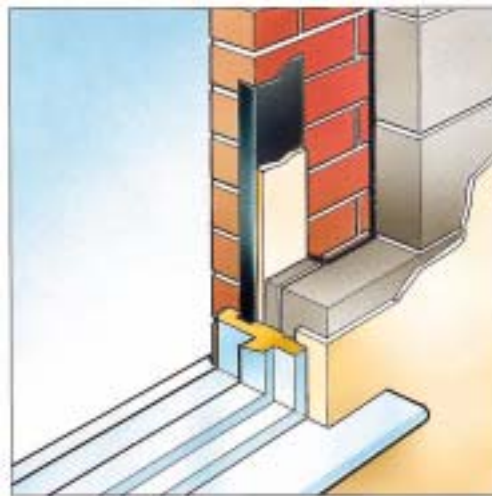

- * Thermal bridging solution
- * Strong yet flexible design
- * Meets Building Regulations
- * Any width to suit application



FM 11012

Peel Industrial Estate - Chamberhall St - Bury - Lancashire BL9 OLU

Tel: 0161-447-8320 Fax: 0161-447-8333 E-mail: sales@mayplas.co.uk

Mayplas

Product Specification 555 Thermal Cavity Closer

The product consists of Tissue Faced Rockfibre Slab laminated to Black Polyethylene dpc. The dpc forms a 40mm flange on each side of the insulation and a 100mm flange at the bottom edge

Insulation Length:	1200mm
Insulation Width:	100mm, 150mm, 190mm
Insulation Thickness:	20mm, 50mm
Thermal Conductivity:	0.035 W/mK
R Value:	1.42 m ² K/W (50mm)

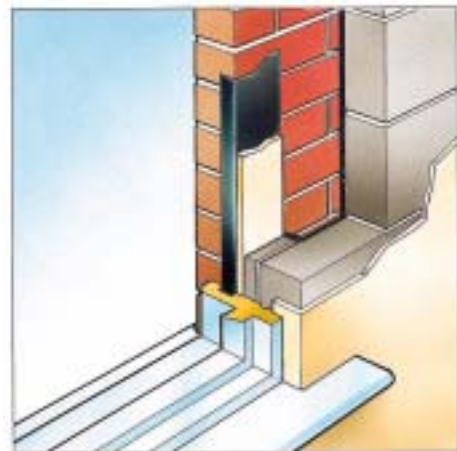

Fixing

Mayplas Thermal Cavity Closer should be fitted during the building process and before installation of door and window frames:-

The product should be fitted dpc side against the inner face of the outer brickwork with one of the 40mm flanges being folded against the door / window frame in the normal way and the other vertical 40mm flange remaining flat against the outer brickwork

If more than one length of Mayplas Thermal Cavity Closer is needed it should be fitted with the 100mm dpc flange at the bottom, with the next closer forming a close butt joint over the flange

At the top of the vertical cavity it should be sealed to the underside of the lintel or fitted behind the cavity tray

